

THE Christmas Model Railway Show

- *Disabled Access*



The entrance to the Sugden Centre is step free from a paved piazza. Since this photograph was taken some fixed seating and tables have been installed, but do not present an obstruction.

The entrance for all visitors to the exhibition, is through the door with the silver coloured surround. The revolving door on the right is for the use of gym visitors only.

The door is not power assisted, but an MMRS steward will be on hand to give assistance if needed. This door gives access to the front part of the lobby. Entrance to the exhibition is through the ticket barrier which has two turnstiles and a powered access gate, operated by a steward.

Those parts of the centre being used by the exhibition are step free throughout.

Hall 2 is reached directly from the lobby through two sets of double doors.

At the rear of the lobby there is a double door leading to Hall 1. Immediately beyond this door is the first aid room and one of the unisex accessible toilets.

From this point the corridor slopes up for about 5m at a very gentle slope.

Hall 1 is reached through double doors at the end of this corridor.

The second unisex accessible toilet is reached **through** Hall 1 and is directly opposite the exit of that Hall.

The corridor shown on the plan at the rear of Halls 1 is narrow, and a one-way system will be in force.

The emergency exits from Hall 2 have (inexplicably) a step down from the hall to the pavement. Stewards have been instructed to direct visitors with mobility issues to exit via the lobby in the case of an emergency.

All non-emergency entry/exit doors to both halls are normally propped open with a steward on duty.

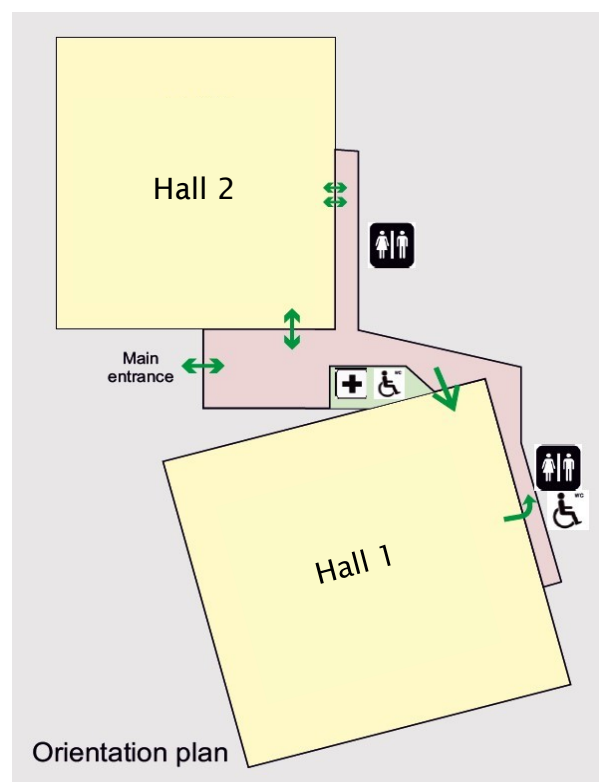

Parking

There is no public car park at the venue itself. Visitors arriving by car should normally park in the Aquatics Centre car park, about 300m away.

However, there is some on-street parking in Sidney Street and Grosvenor Street which includes nine Blue Badge bays. There are also four Blue Badge spaces on the forecourt of the venue, a few metres from the entrance, **but these MUST be booked in advance by contacting MMRS by email to exhibition@mmrs.co.uk**

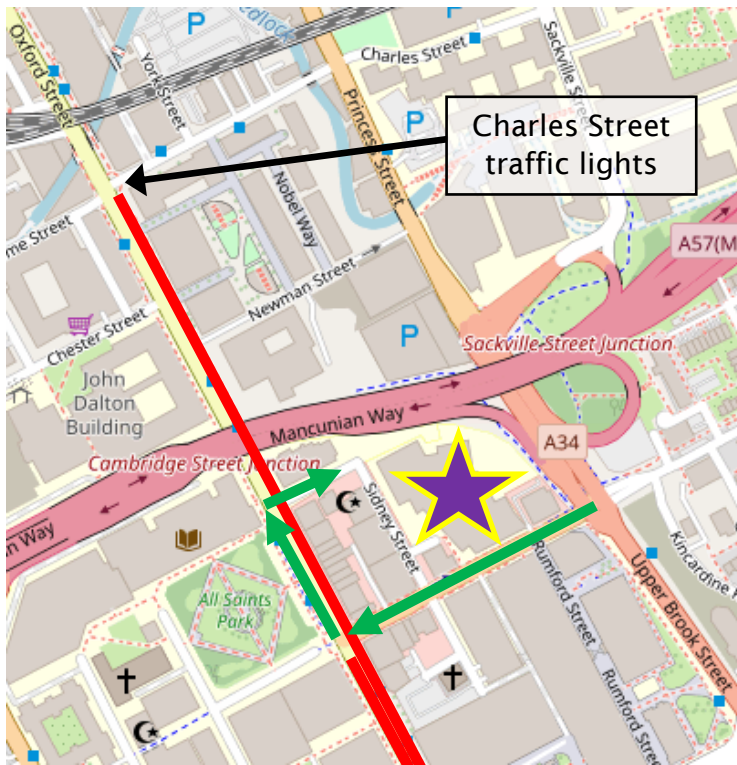

The venue is located within a Busgate one-way system (shown by the red lines) which is rigorously enforced, with significant fines. The **ONLY** road access **TO** the venue is from Upper Brook Street.

Turn into Grosvenor Street, then, at the end, turn **RIGHT** into Oxford Road, then **RIGHT** again into Sidney Street.

Only buses and taxis are allowed on the road sections marked red.

To leave the Sugden Centre, continue along Sidney Street and turn **RIGHT** into Grosvenor Street, then **RIGHT** again into Oxford Road. Continue along

Oxford Road, under the Mancunian Way, to the traffic lights at Charles Street.

Turn **RIGHT** for the A34, A57 and A6. For all other routes out of central Manchester, carry straight on to the next traffic lights at Whitworth Street, where there is a **compulsory LEFT** turn.

MMRS will not be liable for any fines incurred as a result of infringing the Busgate regulations.

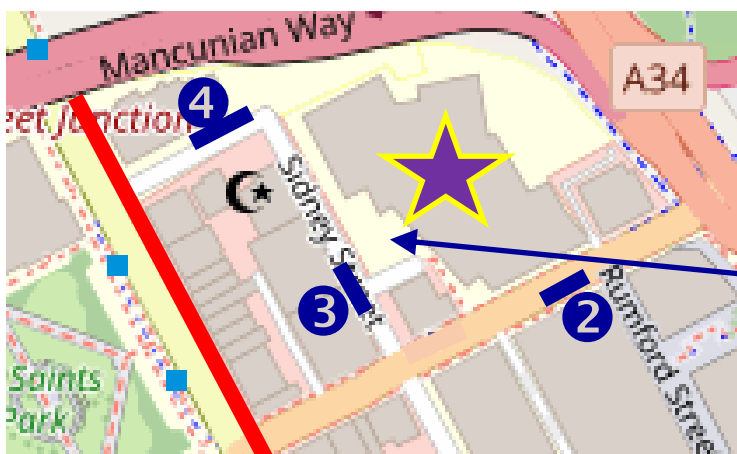

The nine on-street Blue Badge bays are marked on this diagram. The two bays in Grosvenor Street are on the wrong side of the street for the venue.

Four bookable Blue Badge spaces (half day slots).
Contact: exhibition@mmrs.co.uk